

# JIMMY

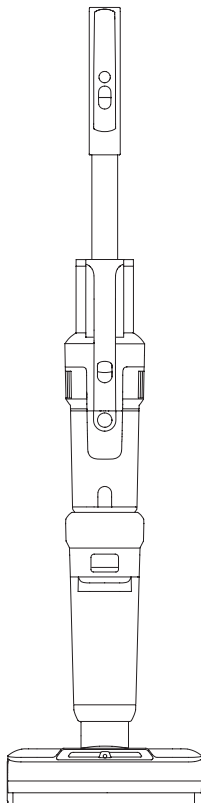

## HW10

Instruction Manual	3 in 1 Full House Cleaning Cordless Vacuum&Washer
Manuale d'uso	Aspirapolvere e lavapavimenti senza fili 3 in 1 per la pulizia della casa completa
Gebrauchsanweisung	3-in-1 kabelloser Staubsauger für das ganze Haus
Инструкция по эксплуатации	Беспроводная пылесосная поломоечная машина «три в одном» для целого дома
Mode d'emploi	Aspirateur sans fil 3-en-1 pour toute la maison
Instrucciones de uso	Aspirador inalámbrico 3 en 1 para toda la casa
Instrukcja Obsługi	3 w 1Bezprzewodowy odkurzacz i mop



## Contents

English	2
Italiano	15
Deutsch	29
русский язык	43
Français	57
Español	71
Polski	85

# Product Assembly

## Parts Name

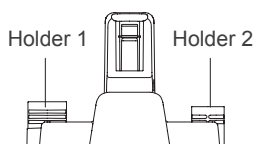
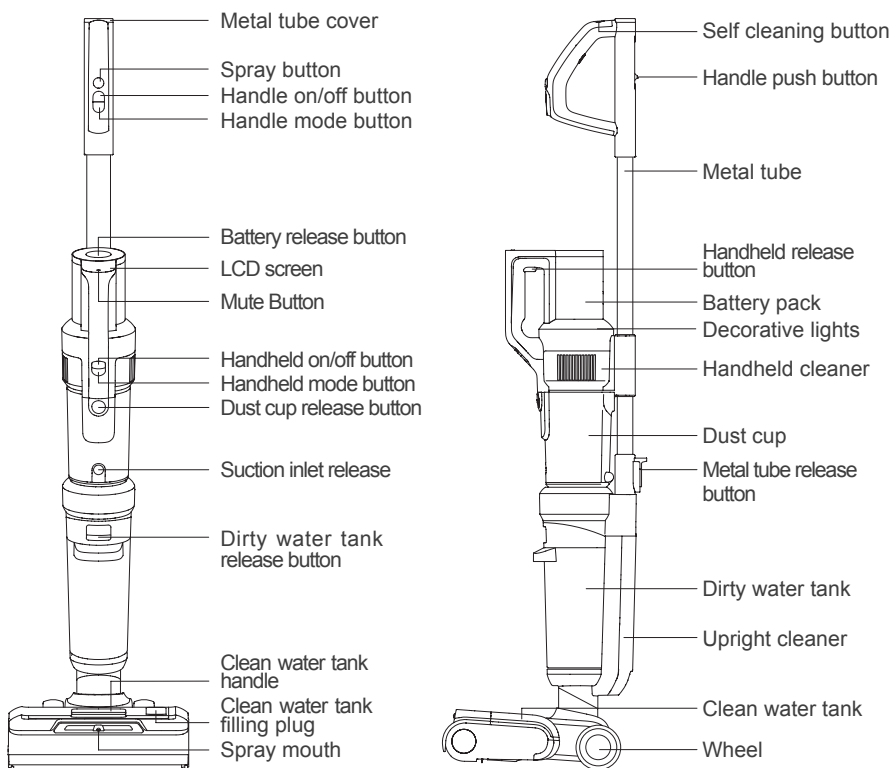

Charging base



Cleaning brush



Cleaning solution



Upholstery tool



Adaptor

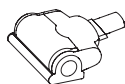

Electric mattress head

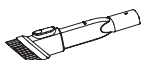

Crevice tool



Carpet brushroll

# Packing List

Handheld cleaner	Floorhead	Metal tube	Battery pack	Charging base	Adaptor	Carpet brushroll	Cleaning brush
1	1	1	1	1	1	1	1
Electric mattress head	Upholstery tool	Crevice tool	Cleaning solution	Holder 1	Holder 2	Instruction Manual	
1	1	1	1	1	1	1	

## Product assembly and disassembly

Note: Cut off electricity before product assembly and disassembly.

### Metal tube assembly and disassembly

Insert the metal tube into the mainbody vertically until a "click" sound is heard. Make sure metal tube is firmly locked (Fig 1). To remove the metal tube, push the metal tube release button down to the end and pull the metal tube upward. (Fig 2)

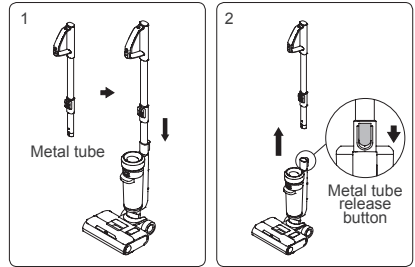

### Battery pack assembly and disassembly

1. Slide battery pack along the slot and press the battery pack down firmly until a "click" sound is heard. The battery pack is locked.

2. Press the battery pack release button and pull the battery pack in the direction opposite to the assembly to unlock the battery pack.

Note: Except for the replacement of the battery pack, the battery pack doesn't need to be taken out frequently.

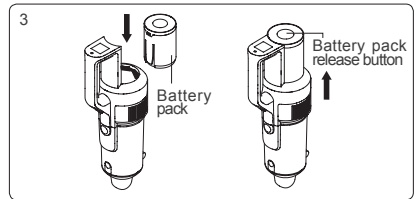

### Handheld vacuum cleaner assembly

Insert the dust cup suction inlet of the handheld vacuum into the groove of the mainbody cover. Push the handheld cleaner towards the metal tube until a "click" sound is heard, the handheld vacuum cleaner is installed successfully to mainbody. And machine is used as an upright vacuum cleaner at this time (Fig 4). To remove the handheld vacuum cleaner, just press the handheld release button and lift the handheld vacuum cleaner diagonally upwards. (Fig 5)

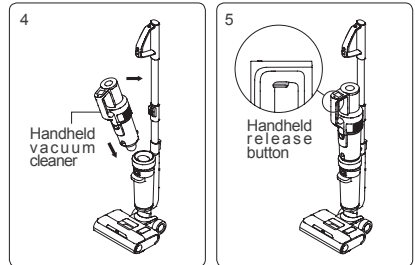

### Charging holder assembly (Fig 6)

Press the holder 1 and holder 2 into the charging base until a "click" sound is heard.

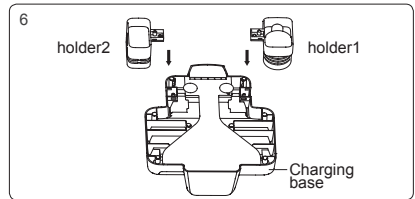

## Place machine to charging base(Fig 7)

To put machine back to charging base, hold machine handle to lift the machine., aim charging slot on bottom of machine to the charging socket on charging base and put the machine into charging base. To use the machine, hold machine handle and lift out machine from charging base.

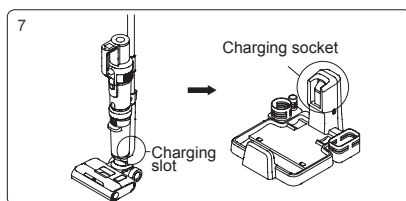

## Dirty water tank assembly and disassembly

To take off dirty water tank, hold machine with one hand and hold dirty water tank with another hand, press dirty water tank release button to pull out dirty water tank. (Fig 8-1)

To assemble dirty water tank, place dirty water tank bottom into mainbody, push dirty water tank towards mainbody until a "click" sound is heard. (Fig 8-2)

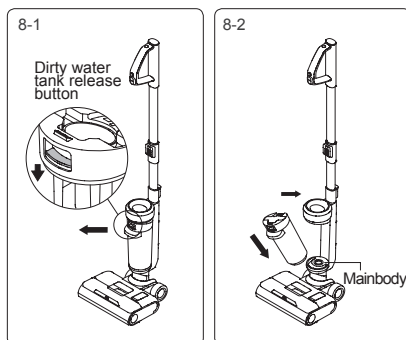

## Brushroll window and brushroll assembly and disassembly

To take off brushroll window, hold brushroll window latch and pull upward to remove brushroll window.

To assemble brushroll window, align the clips on two sides of brushroll window with the slots on two sides of floorhead. Press brushroll window down until a "click" sound is heard. (Fig 9)

To disassemble the brushroll, pull the brushroll cap outward to take out brushroll. To assemble the brushroll, hold brushroll cap, slide brushroll over the cylinder until brushroll reaches the end. (Fig 10)

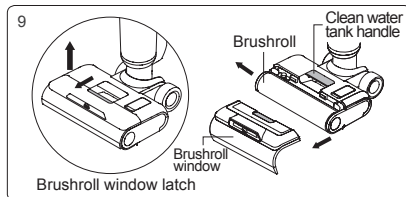

## Clean water tank assembly and disassembly

To take off clean water tank, hold the clean water tank handle and pull out the clean water tank. To assemble clean water tank, put the clean water tank back to nozzle, align with the brushroll window. (Fig 11)



## Use of the Product

Note: When using it for the first time, please fully charge the machine before using it.

### Use of upright vacuum cleaner

Press the handle on/off button, the LCD screen and decorative lights will light up, default is in Auto mode (Fig 12), press the mode button to switch to Floor mode (Fig 13), press the mode

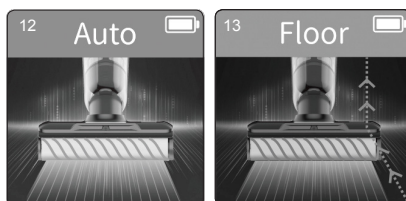

button twice to switch to Turbo mode (Fig 14) , press the mode button three time to switch to Carpet mode(Fig 15). Press the mode button again to go back to Auto mode. Press the handle on/off button again to turn off the machine, the display screen and the decorative lights go out.

Note:

1. When cleaning carpet, please clean the floorhead first (refer to " Cleaning and Maintenance, Floorhead Cleaning" for details) and replace the carpet brushroll.
2. When the battery level is lower than 20%, it cannot be switched to Carpet mode and Turbo mode.

## Water spray function

When upright vacuum cleaner is working, press the water spray button, the spray mouth sprays fan-shaped water; release the water spray button to stop spraying water. (Fig 16)

## Use of handheld vacuum cleaner

Take off handheld cleaner, press the handheld on/off button, the display and decorative lights will light up, default is in ECO mode (Fig 17), press the handheld mode button to switch to MAX mode (Fig 18), Then press the handheld mode button to switch back to ECO mode; Press the handheld on/off button again to turn off the machine, the display screen and the decorative lights go out.

The handheld vacuum cleaner can be connected with upholstery tool, crevice tool, electric mattress head or metal tube, to clean different areas.

- 1.Connect with upholstery tool to clean the dust and particles on furniture surface . (Fig 19-1)
- 2.Connect with metal tube to clean dust on high places. Open the metal tube top cover, push the handle button upwards to extend the metal tube, and then insert the tube to suction inlet of the handheld vacuum cleaner to clean the dust in high place. (Fig 19-2)
- 3.Connect with crevice tool to clean narrow places. (Fig 19-3)
- 4.Connect electric mattress head to clean dust, hair, dust mite ect on bed or fabric sofa. (Fig 19-4)

Note:

1. When the battery is lower than 20%, it cannot be switched to max mode.
2. When using handheld vacuum cleaner, do not vacuum water, otherwise it will cause motor defect.

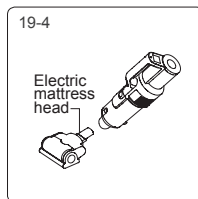
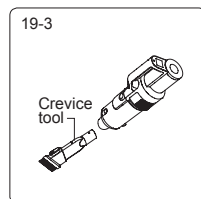
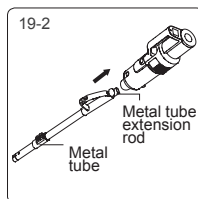
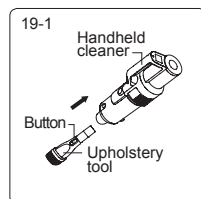
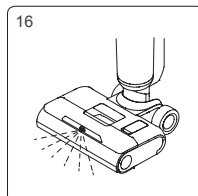
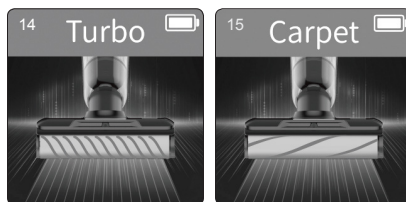

## Machine charging

Connect the adapter to the power supply, put the upright vacuum cleaner into the charging base to start charging.(Fig 20)

Note:

1. Before the first use, please fully charge the battery pack, and before the second charge, please empty the battery to ensure the life of the battery pack;
2. If the product is to be long idled, please charge it once every three months;
3. When not charging, please remove the adapter from the socket to prevent the danger of accidental touching.

## Brushroll air-drying function (Fig 21)

In the charging mode, press and hold the handle mode button for 3 seconds to enter the brushroll air-drying mode for 4 hours. During the air-drying process, the decorative light is on, and the brushroll will rotate slightly at intervals to adjust the air-drying position; Press again mode button to turn off the drying mode.

Note:This mode is designed to prevent humid brushroll from breeding bacteria or odors. (The display is shown in Fig 21)

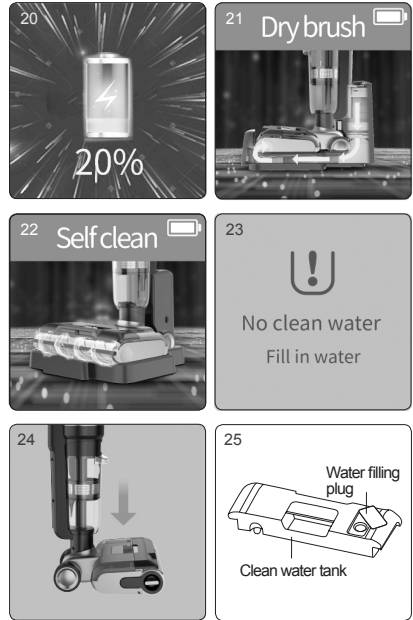

## Brushroll & air path self-cleaning function

In the charging mode, press the self-cleaning button to enter the cleaning mode (The display is shown in Fig 22).After the self-cleaning is completed, the machine enters brushroll air-drying mode and returns to the charging mode; during the self-cleaning process, to end the self-cleaning mode in advance , press on/off button and machine will return to charging mode.

Note:

1. Self clean mode is only to clean floorhead air path and hardfloor brushroll. Do not run self clean on the carpet brushroll.
2. Before turning on the self clean mode, please empty dirty water in the dirty water tank first, check that the machine has been firmly placed on the charging stand, the adapter is plugged into the socket and connected to the charging stand. The clean water tank retains at least 1/2 water volume; After completing self cleaning, please clean the dirty water tank again.
3. When the battery is less than or equal to 10% power, the self-cleaning mode cannot be turned on, and it can be turned on normally after charging for a period of time.

## Clean water tank empty indicator

When using the water spray function, the voice/screen shows "No clean water, fill in water" (Fig 23 and Fig 24 alternately display), please turn off the machine and add water to the clean water tank.When using the clea self clean mode, if it is detected that there is no water in the clean water tank, the brushroll self cleaning will be stopped. To continue self cleaning, please add water to the clean water tank and empty the dirty water tank, then restart self clean mode.

Note:When adding clean water, you can add the equipped JIMMY cleaning solution, the ratio is about 1 bottle cap of cleaning solution to one full water tank, the water temperature cannot exceed 40°C.

Fill up clean water tank: After removing the clean water tank, open the water filling plug, turn it to the side to expose the water inlet hole, pour clean water and cleaning solution in, and then plug back to the original position and reinstall the clean water tank to floorhead. (Fig 25)



## Dirty water tank full indicator

When the upright vacuum cleaner detects that the dirty water tank is full, the whole machine will stop and give a voice reminder. Please clean the full dirty water tank and put it back. (Fig 26 and Fig 27 alternately display)

When it is detected that the dirty water tank is full in self clean mode, the machine will stop working and give a voice reminder. Please clean the full dirty water tank and put it back.

**Dirty water tank cleaning:** Take out dirty water tank upper cover and filter frame, dump the dirty water, assemble the dirty water tank after washing, and put it back on the floorhead. (refer to "Cleaning and Maintenance of dirty water tank" for details)

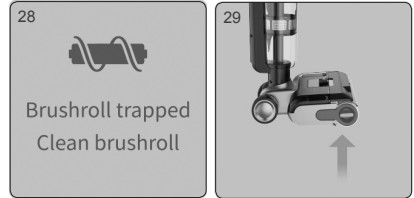
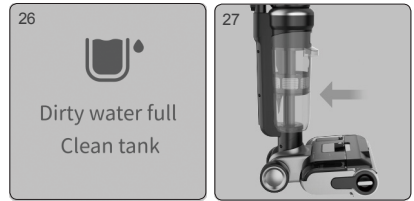

## Brushroll stuck indicator

When the cleaner is in working or cleaning mode, if the brushroll is stuck, the whole machine will stop and give a voice reminder. (Fig 28 and Fig 29 alternately display) Please take out the brushroll, clean up the foreign matter or entangled hair on the brushroll.

**Brushroll cleaning:** After removing the window, pull out brushroll, use the blade on the cleaning brush to cut the hairs winding on brushroll, and clean the foreign matter attached to the brushroll and floorhead. Install brushroll and window back. (Fig 30) (refer to "Cleaning and Maintenance of Floorhead Assembly " for details)

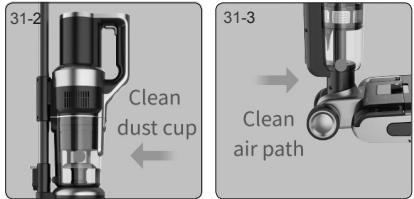
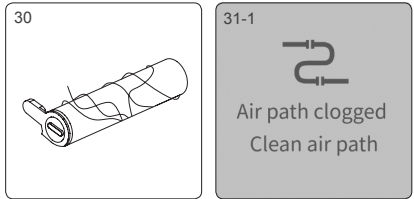

## Air path blocked indicator

When the upright cleaner is in working or self clean mode, if the air path is blocked, the machine will stop working and give a voice reminder. Please follow the instruction on display screen to check the possible blocked parts and clean up.

When handheld vacuum cleaner is working, if the air path is blocked, cleaner will automatically stop. At this time, the dust cup and HEPA need to be cleaned. (The content displayed on the screen is: the blockage of the upright vacuum cleaner is shown in Fig 31-1、31-2、31-3、31-4、31-5, and the blockage of the handheld vacuum cleaner is shown in Fig 31-1、31-2)

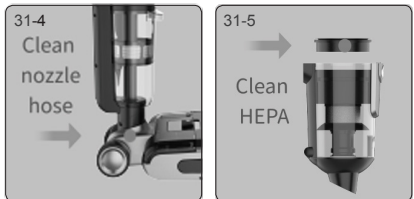

**Air path cleaning:**

1. Disassemble the dirty water tank, take out dirty water tank upper cover and filter, wash all parts and then assemble back.
2. Use pipe brush to clean the dirt, foreign objects and hair inside air path of floorhead.
3. Remove the dust cup, empty the dust cup, remove HEPA, then take out cyclone and disassemble it, clean all parts and reassemble the dust cup. (Refer to "Cleaning and Maintenance" for details)

## Voice function

The voice of the new machine is turned on by default, press the mute button to turn off the voice function; press the mute button again to turn on the voice function. (Fig 32)

Note:When using handheld vacuum cleaner, there is no voice function.

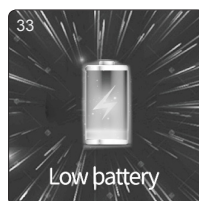
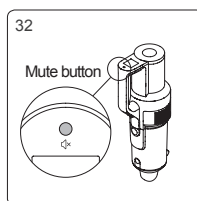

## Battery power indicator

When the upright cleaner is working, if the voice reminds " Low battery. Please charge the battery ", Please use it after charging. (Fig 33)

When the upright cleaner is working, if the voice reminds " Low battery. Machine will be turned off soon. Please charge the battery ", the power is about to be exhausted, and it will automatically shut down. Need to charge for use.

When using vacuum cleaner, the icon on top right corner of the screen displays left battery power: full grid means 75% to 100% battery; 3/4 grid means to 50% to 75% battery; 1/2 grid means 25% to 50% battery; 1/4 grid means 1% to 25% of the battery; the blank means the battery being empty, and it needs to be charged before use.

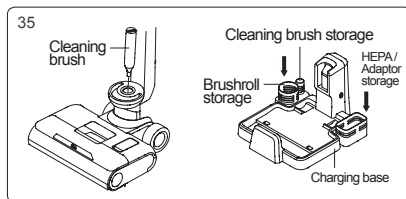
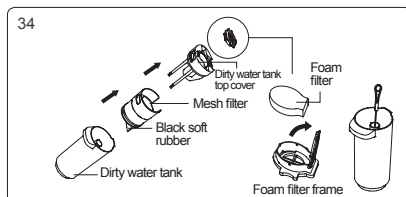

## Cleaning and Maintenance

### Dirty water tank cleaning(Fig 34)

After turning off the vacuum cleaner, remove the dirty water tank, lift the water tank top cover, and remove the foam filter frame from it, open the flip cover of the foam filter frame, take out the foam filter. Pour out dirty water and dirt in the water tank, then wash dirty water tank, water tank cover, foam filter frame and foam filter. If there is foreign matter in the dirty water tank pipe, it can be cleaned with a cleaning brush; dry the above parts after washing. And then reassemble all the parts back into dirty water tank.

Note:

1. After using upright vacuum cleaner, it is recommended to clean the dirty tank immediately;
2. When reinstalling the filter,do not fold the black soft rubber under the filter.

### Floorhead cleaning (Fig 35)

After removing the brushroll window, brushroll, clean water tank, and dirty water tank, insert the cleaning brush through the circular hole below the installation position of the dirty water tank to clear foreign matter and scales in the pipe, and the clogged hair; Use the blade on the cleaning brush cut off the entangled hair on the brushroll; Wipe the dirty parts of the machine (the brushroll can be placed in the accessory holder for drying ).

Note:Do not wash the floorhead separately after removing the brushroll.

## Dust cup cleaning (Fig36-1,36-2)

Press the dust cup release button to remove the dust cup from the handheld vacuum cleaner; press the suction inlet release button to open the suction inlet and empty the dust cup; Take out the cyclone assembly ; Take out the HEPA filter; Hold the metal mesh, rotate it to unlock the metal mesh, and then remove it downward.

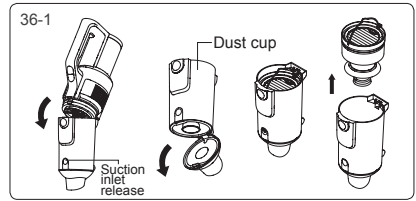

After cleaning, wiping, and drying each part, assemble the dust cup in turn, and then installed on the handheld vacuum cleaner.

## Maintenance and Storage

it is recommended to clean the dirty water tank, filter, brushroll and brushroll window after each use. If there is any of below situation: ( ① HEPA filter leaks dust; ② Foam filter severely damaged; ③ The brushroll has serious hair loss, or has strong vibration and abnormal noise during use), it is recommended to purchase consumables and replace it to avoid machine performance.

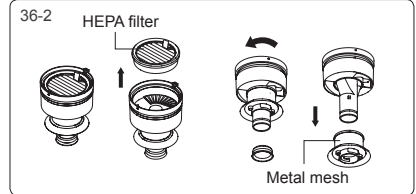

when the machine is long idled, place it in a cool and dry place, avoid direct sunlight or wet environment.

When pack and store the machine, Please be sure to clean the machine and dry all parts to prevent damage to the machine.

## Important Safety Instructions

Read all instructions and warnings before using this appliance. Failure to follow the warnings and instructions may result in electric shock, fire or serious injury.

### Warning

- 1.The appliance is only for household use.
- 2.Before use the product, check whether the local voltage is consistent with the voltage marked on the power adaptor.
- 3.Inspect the product before use, stop use if the product or adaptor is damaged.
- 4.Use only as described in this manual.
- 5.This appliance cannot be used by children and persons with reduced physical, sensory or mental capabilities or lack of experience and knowledge unless they have been given supervision or instruction concerning use of the appliance in a safe way and understand the hazards involved.
- 6.Do not use this product as a toy. Keep this product away from the reach of children. Take care of children and make sure they will not regard this product as a toy.
- 7.Do not touch plug with wet hand.
- 8.Use extra care when cleaning on stairs to prevent falling.
- 9.Do not use or disassemble or replace any component if there is damage on power cord, plug, battery or conductive parts. Disassembly or replacement of the components by yourself may

cause electric shock or fire. JIMMY will not take responsibility. Once damaged, the product need to be repaired or replaced by JIMMY, JIMMY's distributor or qualified person designated by JIMMY to avoid injury.

10.Recharge only with the adaptor specified by JIMMY.

11.Only to use the battery pack specified by JIMMY. Use of any other battery pack may cause explosion, injury and or product damage.

12.If the product does not operate in accordance with the instructions, is seriously impacted, falls from a height, is damaged, or falls into the water, do not use it and contact JIMMY or JIMMY distributor .

13.Only use JIMMY specified replacement parts or attachments.

14.Do not pull or press the cable. Keep cable away from heated surfaces. Do not place the cable in a closed door or pull it through a sharp edge or corner. Keep the cable away from walking area. Do not operate product across the cable.

15.Unplug the product when it is not used or before repairing.

16.Do not drag the cord or carry cord to move the product, or use cord as handle.

17.The product is a rechargeable electric appliance. Do not leave the machine to run unattended.

18.Remove battery pack when the product is cleaned, repaired or long idled.

19.Do not get close to heating appliance or expose under sunshine longtime, to prevent over heating causing housing deformation.

20.Keep objects that may obstruct air path from air inlet and outlet to prevent machine overheating.

21.Product mainbody and floorhead have electric components, cannot be washed under water.

22.Do not clean or disassemble brushroll cover or brushroll when the machine is power on or under working to prevent injury.

23.Do not use the product to pick up flammng objects like burning charcoal or cigarette etc.

24.Do not use the product to pick up sharp objects like broken glass.

25.Do not use the product to pick up lime, cement, toner, gypsum powder, flour and other ultra-fine substances.

26.Do not use the product to pick up acid-base cleaning liquid, washing powder and other corrosive liquids.

27.Do not use the product to pick up inflammable and explosive objects like gasoline, alcohol, perfume, paint, etc.

28.Do not disassemble the closed machine, and do not try to change the performance of the machine. Only get help from the professional personnel of the manufacturer, its maintenance department or similar departments, otherwise it will cause danger.

29.Turn off power and unplug charger if the products is long idled.

30.Product technical specification of this manual are based on results from lab tests of JIMMY or designated third parties. The company reserves all rights for final explanations.

## About use of the product

- 1.This product is suitable for hard floor in indoor environment, including waxed floor, rubber floor, tile floor and sealed wood floor, solid wood floor and other flat surface, use of the product on unflat ground may not achieve the best effect.
- 2.Do not turn on the machine before dirty water tank and clean water tank are assembled in place according to instruction.
- 3.Do not shake the product up and down or collide violently to prevent dirty water from flowing into the motor; when the product is turned on, do not lift or carry the machine up and down, and do not tilt the product to one side or lay it flat on the floor to prevent dirty water from flowing into the motor.
- 4.Do not run the product for a long time with the float blocking the air inlet to avoid damage.
- 5.After using the product, clean the dirty water tank, suction nozzle, air path and store it in ventilated and dry place. Wet place will affect the insulation and life of electrical appliances.

## About Cleaning Solution

- 1.A large amount of cleaning solution entering into the motor may cause damage to the appliance.
- 2.Mix the solution with clean water according to the instructions (the ratio of solution to clean water is 1:50). It is recommended to use provided cleaning solution. Do not use cleaning solution contains acid, alkali,alcoholic solution or substances harmful to the environment.
- 3.Keep cleaning solution out of reach of children. If any solution gets into the eyes, immediately flush them with clean water. If any solution is swallowed by accident, see medical care immediately.
- 4.Dirty water and solution disposal should comply with local environmental regulations.

## About disposal of battery

- 1.The battery in the product contains materials harmful to the environment. Take out the battery pack from the product before disposal.
- 2.Turn off the product and unplug adaptor before taking out battery pack.
- 3.Handle the waste battery pack safely and properly. Do not put it into fire, water or soil.
- 4.If the disposed battery leakage causes pollution to skin or clothes, Wash with clean water and see medical care immediately.

# Troubleshooting

Please check the following points before contacting the after sale service.

Problem	Possible cause	Solution
Can not start or stop during use	Low battery power	Recharge battery
	On/off button is not pressed down	Press down on/off button
	Brushroll is entangled	Clean brushroll
	Dirty water tank full	Clean dirty water tank
	Battery pack not assembled properly	Reassemble battery pack
	Suction inlet blocked	Clean suction inlet and filter
Weak suction	Suction inlet blocked	Clean suction inlet and filter
	No HEPA assembled	Assemble HEPA
Abnormal noise	Suction inlet blocked	Clean suction inlet and filter
	No HEPA assembled	Assemble HEPA
Spray mouth does not spray water	Clean water tank empty	Fill clean water tank
	Water spray button not pressed	Press water spray button
	Clean water tank not assembled properly	Reassemble clean water tank
Water spray out from air path	HEPA and dust cup are put to use without fully dry	Dry the HEPA and dust cup after washing before use
	Metal filter is not assembled in the dirty water tank	Assemble metal filter in dirty water tank
	Soft plastic folds under the filter	Reassemble the filter, the soft glue must not be folded

Note: If the above troubleshooting guide fails to provide a solution or the screen displays error code F1 to F8, please contact after service or local distributor for support.

 System error contact after service	<b>F1</b> Battery failure	<b>F2</b> Charger failure	<b>F3</b> Vacuum motor short-circuited	<b>F4</b> Battery cell failure
<b>F5</b> Vacuum motor over current protection	<b>F6</b> Vacuum motor over current protection	<b>F7</b> Serial communication error	<b>F8</b> NTC failure (short or open circuit)	

# Product Specification

## Technical parameters

Product name	Cordless Vacuum&Washer
Model	HW10
Rated Power	400W
Rated Voltage	25.2V---
Battery Capacity	3800mAh
Charging Time	4h
Adaptor Input	100-240V ~ 50-60Hz

## Circuit

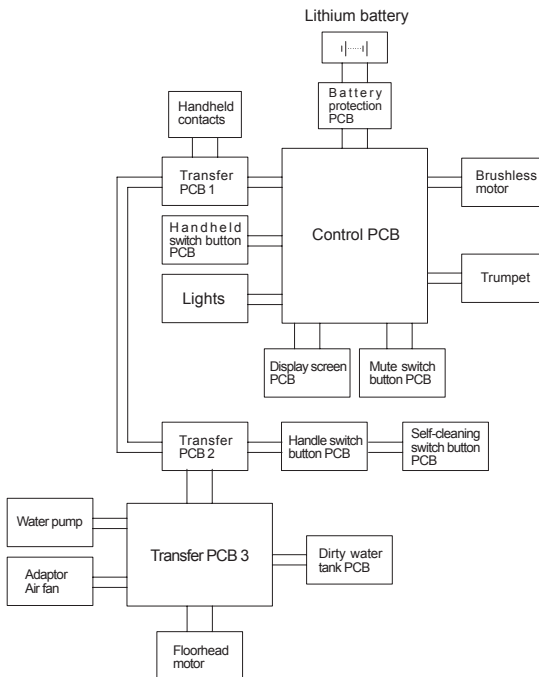

## Manufacturer Information

Manufacturer	Kingclean Electric Co., Ltd
Address	No.1 Xiangyang Road, Suzhou New District, Jiangsu Province 215009, China



## Disposal

The machine, accessories and packaging should be sorted for environmental-friendly recycling.



Do not dispose of the machine into household waste!

## Only for EC countries:

According to the European Guideline 2012/19/EU, machine that are no longer usable, and according to the European Guideline 2006/66/EC, defective or used battery packs/batteries, must be collected separately and disposed of in an environmentally correct manner.

## Battery packs/batteries:

Integrated batteries may only be removed for disposal by qualified personnel. Opening the housing shell can damage or destroy the machine.

Do not dispose of battery packs/batteries into household waste, fire or water. Battery packs/batteries should, if possible, be discharged, collected, recycled or disposed of in an environmental-friendly manner.

Subject to change without notice.

## Warranty Information

This product enjoys two years warranty from the date of purchase.

Excluded from the guarantee is normal wear, commercial use, alterations to the appliance as purchased, cleaning activities, consequences of improper use or damage by the purchaser or a third person, damage, that can be attributed to external circumstances or caused by the batteries.









1K-01

# JIMMY



Contact us -we'll get back within 1 business day.



Web:[www.jimmyglobal.com](http://www.jimmyglobal.com)  
Email:[support@jimmyglobal.com](mailto:support@jimmyglobal.com)