

Aqara

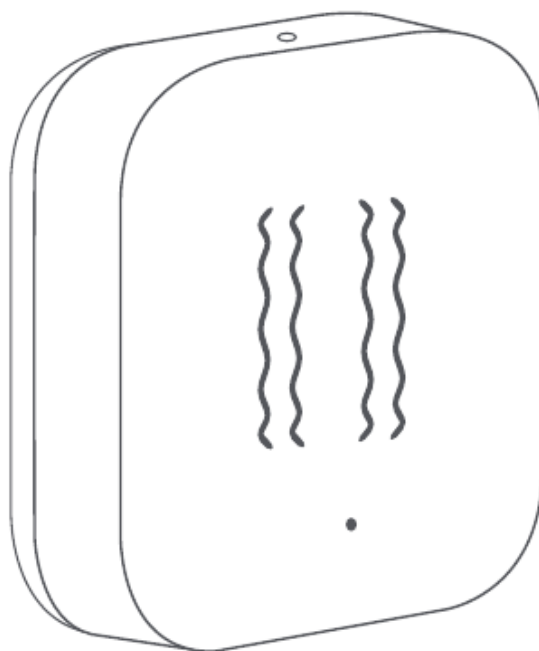

VibrationSensor

Vibration Sensor Quick Start Guide

English

Product Introduction

Aqara Vibration Sensor is embedded with a high precision acceleration sensor and it detects the vibration and movement of objects. It communicates with the Hub via Zigbee protocol. It also works with other smart accessories to set various smart scenes, such as, local and remote alarm when it detects glass breaks.

- * A hub is required.
- * Aqara Hub is required to enable Aqara Vibration Sensor to work with HomeKit technology. See www.aqara.com for more details.
- * This product is for indoor use only.

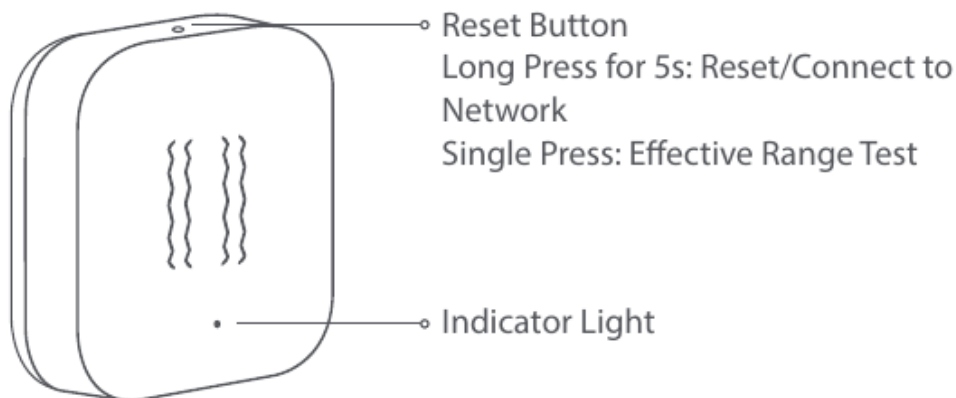

Quick Setup

1. Before activating the accessory, please make sure you have the Aqara Home app downloaded and Aqara hub installed.
2. Please open the app, tap "Home" and then tap "+" in the top right corner to enter "Add Device (Accessory)" page. Select "Vibration Sensor", and add it according to instructions.

* If the connection fails, please move the accessory closer to the Hub and try again.

Installation

Effective Range Test: Single press the reset button on the accessory at your desired position. If the Hub makes voice prompts, it indicates that the accessory can communicate effectively with the Hub.

* Avoid metal surface to maximize signal strength.

Option 1: Place it directly in the desired position.

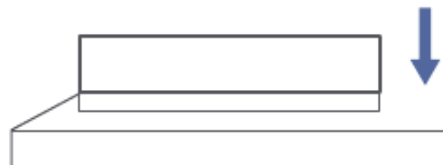

Option 2: Remove the protective film, and stick it to the desired position.

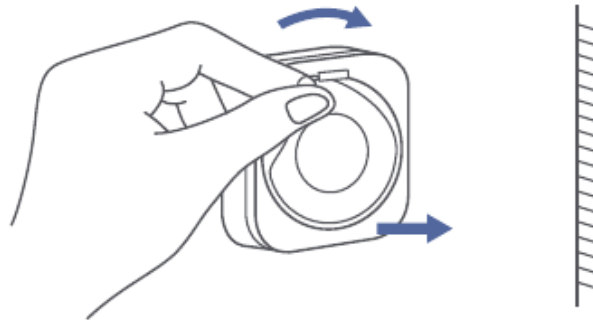

English

* Keep the surface clean and dry.

Specifications

Model: DJT11LM

Dimensions: 36 × 36 × 9 mm (1.42 × 1.42 × 0.35 in.)

Wireless Protocol: Zigbee

Battery: CR2032

Operating Temperature: -10° – +50°C (14°F – 122°F)

Operating Humidity: 0 – 95% RH, no condensation

Maximum Transmit Power (Zigbee): 9.99dBm

Working Frequency: 2400 MHz – 2483.5 MHz

Online Customer Service: www.aqara.com/support

Email: support@aqara.com

Manufacturer: Lumi United Technology Co., Ltd.

Address: 8th Floor, JinQi Wisdom Valley, No.1 Tangling Road,
Liuxian Ave, Taoyuan Residential District, Nanshan District,
Shenzhen, China.

English

Warnings

1. This product is NOT a toy. Please keep children away from this product.
2. This product is designed for indoor use only. Do NOT use in humid environments or outdoors.
3. Beware of moisture, do NOT spill water or other liquids onto the product.
4. Do NOT place this product near a heat source. Do NOT place it in an enclosure unless there is normal ventilation. Do NOT attempt to repair this product by yourself. All
5. repairs should be performed by an authorized professional.

6. This product is only suitable for improving the entertainment, convenience of your home life and reminding you about the device status. If a user violates the product use instructions, the manufacturer will NOT be liable for any risks and property losses.

FCC ID: 2AKIT-DJT11LM

Federal Communications Commission (FCC) compliance statement:

1. This device complies with part 15 of the FCC Rules.

Operation is subject to the following two conditions:

- (1) This device may not cause harmful interference, and
 - (2) this device must accept any interference received, including interference that may cause undesired operation.
2. Changes or modifications not expressly approved by the party responsible for compliance could void the user's authority to operate the equipment.

Note: This equipment has been tested and found to comply with the limits for a Class B digital device, pursuant to part 15 of the FCC Rules. These limits are designed to provide reasonable protection against harmful interference in a residential installation.

This equipment generates, uses and can radiate radio frequency energy and, if not installed and used in accordance with the instructions, may cause harmful interference to radio

communications. However, there is no guarantee that interference will not occur in a particular installation. If this equipment does cause harmful interference to radio or television reception, which can be determined by turning the equipment off and on, the user is encouraged to try to correct the interference by one or more of the following measures:

- Reorient or relocate the receiving antenna.
- Increase the separation between the equipment and receiver.
- Connect the equipment into an outlet on a circuit different from

that to which the receiver is connected.

-Consult the dealer or an experienced radio/TV technician for help.

RF Exposure statement:

This equipment complies with FCC radiation exposure limits set forth for an uncontrolled environment. This equipment should be installed and operated with minimum distance of 20 cm between the radiator and your body. This transmitter must not be co-located or operating in conjunction with any other antenna or transmitter.

IC: 22635-DJT11LM

IC NOTICE TO CANADIAN USERS

This device contains licence-exempt transmitter(s)/receiver(s) that comply with Innovation, Science and Economic Development Canada's licence-exempt RSS(s). Operation is subject to the following two conditions:

(1) This device may not cause interference.

(2) This device must accept any interference, including interference that may cause undesired operation of the device.

This Class B digital apparatus complies with Canadian ICES 003.

This device complies with RSS 247 of Industry Canada.

Operation is subject to the condition that this device does not cause harmful interference.

This equipment complies with IC radiation exposure limits set forth for an uncontrolled environment. This equipment should be installed and operated with minimum distance of 20 cm between the radiator and your body. This transmitter must not be co-located or operating in conjunction with any other antenna or transmitter.

L'émetteur/récepteur exempt de licence contenu dans le présent appareil est conforme aux CNR d'Innovation, Sciences et Développement économique Canada applicables aux appareils radio exempts de licence. L'exploitation est autorisée aux deux conditions suivantes :

- (1) L'appareil ne doit pas produire de brouillage;
- (2) L'appareil doit accepter tout brouillage radioélectrique subi, même si le brouillage est susceptible d'en compromettre le fonctionnement.

Cet appareil numérique de la Classe B conforme à la norme NMB 003 du Canada.

Cet appareil est conforme à la norme RSS 247 d'Industrie Canada. Le fonctionnement est soumis à la condition que cet appareil ne provoque pas d'interférences nuisibles.

Cet équipement est conforme aux limites d'exposition aux rayonnements de la IC établies pour un environnement non contrôlé. Cet équipement doit être installé et fonctionner à au moins 20cm de distance d'un radiateur ou de votre corps. Cet émetteur ne doit pas

être co-localisé ou fonctionner en conjonction avec une autre antenne ou un autre émetteur.

English



CAUTION

Risk of explosion if the battery is replaced by an incorrect type.

Dispose of used batteries according to the instructions.

Do not ingest battery, Chemical Burn Hazard.

This product contains a coin / button cell battery. If the coin / button cell battery is swallowed, it can cause severe internal burns in just 2 hours and can lead to death.

Keep new and used batteries away from children.

If the battery compartment does not close securely, stop using the product and keep it away from children.

If you think batteries might have been swallowed or placed inside any part of the body, seek immediate medical attention.

1. The equipment is only suitable for mounting at heights ≤ 2 m

2. Disposal of a battery into fire or a hot oven, or mechanically crushing or cutting of a battery, that can result in an explosion
Leaving a battery in an extremely high temperature surrounding environment that can result in an explosion or the leakage of flammable liquid or gas

A battery subjected to extremely low air pressure that may result in an explosion or the leakage of flammable liquid or gas

 Hereby, [Lumi United Technology Co., Ltd.] declares that the radio equipment type [Vibration Sensor, DJT11LM] is in compliance with Directive 2014/53/EU. The full text of the EU declaration of conformity is available at the following internet address:

<http://www.aqara.com/DoC/>

English



All products bearing this symbol are waste electrical and electronic equipment (WEEE as in directive 2012/19/EU) which should not be mixed with unsorted household waste. Instead, you should protect human health and the environment by handing over your waste equipment to a designated collection point for the recycling of waste electrical and electronic equipment, appointed by the government or local authorities. Correct disposal and recycling will help prevent potential negative consequences to the environment and human health. Please contact the installer or local authorities for more information about the location as well as terms and conditions of such collection points.



Symbol on the product or on its packaging indicates that this product may not be treated as household waste. Instead it shall be handed over to the applicable collection point for the recycling of electrical and electronic equipment.

動靜貼快速入門指南

產品介紹

Aqara動靜貼是一款檢測震動的感測器，內建了高精度的加速度感測器，可以感知物體震動、移動等，它透過低功耗的Zigbee通訊技術與閘道器之間進行通訊。可實現諸如檢測到玻璃破碎後聯動閘道器報警，同時將報警訊息推送至手機等的智慧化場景。

*本產品需要配合具備閘道器功能的設備使用；

*欲使本產品相容於HomeKit，需要配備Aqara閘道器，如需更多詳情，請登入www.aqara.com；

*本產品僅限室內使用。

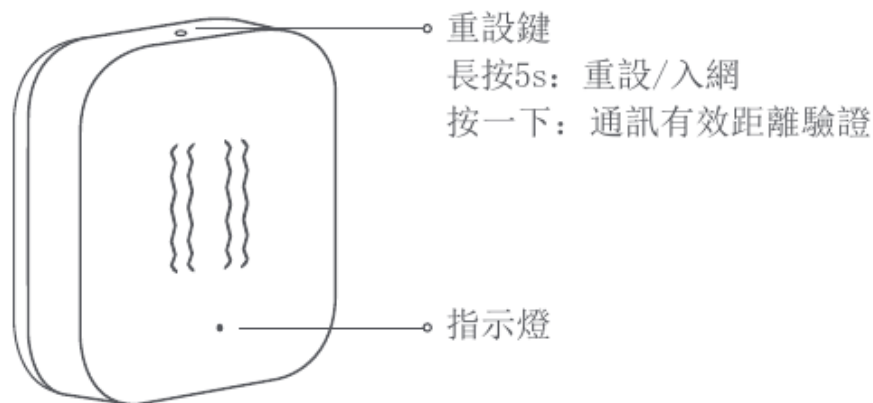

快速設定

- 1、連接設備前，請確保已下載Aqara Home app並添加了閘道器。
- 2、開啟app，點選首頁右上角的「+」，進入「加入設備（配件）」頁面，選擇動靜貼，並依照提示進行操作。

*如加入失敗，請將設備移近閘道器後重試。

安裝方法

有效距離驗證：在預選的安裝位置，按一下設備重設鍵，閘道器發出提示音，表明設備與閘道器之間可以有效通訊。

*為了確保無線通訊穩定，請避免安裝在金屬表面。

方式一：無需粘貼，直接放置在所需位置。

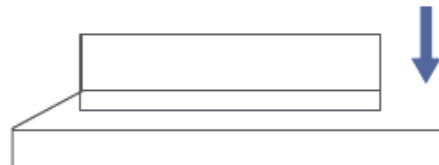

方式二：撕下膠貼保護膜，粘貼在所需位置。

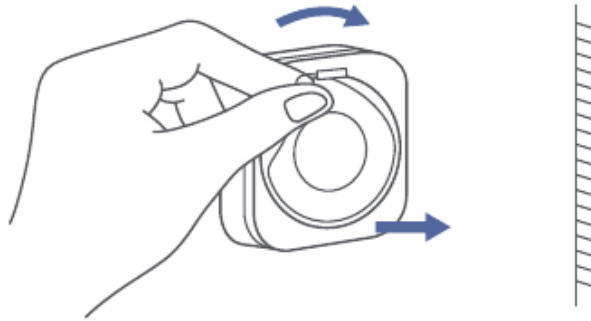

*請確保粘貼位置表面清潔乾燥。

繁
中
文

基本參數

產品型號：DJT11LM

產品尺寸：36×36×9公釐（1.42×1.42×0.35英吋）

無線連接：Zigbee

電池型號：CR2032

工作溫度：-10°C~+50°C（14°F~122°F）

工作濕度：0~95% RH，無冷凝

發射功率（Zigbee）：9.9dBm

工作頻率：2400MHz~2483.5MHz

網站支援：www.aqara.com/support

售後電子信箱：support@aqara.com

製造商：深圳綠米聯創科技有限公司

地址：廣東省深圳市南山區留仙大道塘嶺路1號金騏智谷大廈8樓

使用注意事項

- 1、本產品非玩具，請讓兒童遠離本產品。
- 2、本產品僅限室內使用，請勿在潮濕環境或室內使用。
- 3、注意防潮，請勿將水或液體潑灑在本產品上。
- 4、請勿將本產品置放於靠近熱源的地方。除非有正常的通風，否則不可放在密閉位置中。
- 5、請不要嘗試自行維修本產品，應由授權的專業人士進行此項工作。
- 6、本產品僅適用於提升家居生活娛樂性、便捷度，以及用於設備狀態提醒，如有用戶違反產品使用說明及本注意事項，製造商對因此造成的任何風險和財產損失不承擔責任。

Vibrationssensor – Schnellstartanleitung

Produktübersicht

Der Aqara-Vibrationssensor ist mit einem hochpräzisen Beschleunigungssensor eingebettet, und er detektiert Vibrationen und Bewegungen von Objekten. Er kommuniziert mit dem Hub über das Zigbee-Protokoll. Er kann auch mit anderen intelligenten Zubehörgeräten zusammenarbeiten, um verschiedene intelligente Szenarien zu erstellen – zum Beispiel einen lokalen oder Fernalarm, wenn er einen Glasbruch detektiert.

Deutsch

- * Ein hub ist erforderlich.
- * Damit dieses Gerät mit der HomeKit-Technologie zusammenarbeiten kann, ist ein Aqara-Hub erforderlich. Weitere Einzelheiten siehe www.aqara.com.
- * Dieses Gerät ist nur für Verwendung in Innenräumen bestimmt.

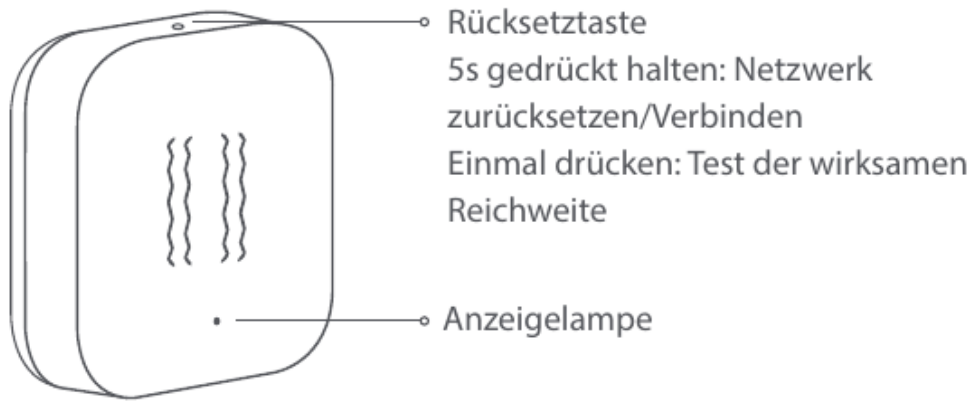

Schnelleinrichtung

1. Bevor Sie das Zubehör aktivieren, stellen Sie bitte sicher, dass Sie die Aqara Home App heruntergeladen und den Aqara hub installiert haben.
 2. Bitte öffnen Sie die App, tippen Sie auf „Home“ (Haus) und dann auf „+“ in der oberen rechten Ecke, um die Seite „Add Device (Accessory)“ (Gerät hinzufügen (Zubehör)) aufzurufen. Tippen Sie auf „Vibration Sensor“ (Vibrationssensor) und fügen Sie ihn gemäß der Anleitung hinzu.
- * Wenn die Verbindung fehlschlägt, geben Sie bitte das Zubehör näher an den Hub und versuchen Sie es erneut.

Spezifikationen

Modell: DJT11LM

Abmessungen: 36 × 36 × 9 mm (1,42 × 1,42 × 0,35 Zoll)

Drahtloses Protokoll: Zigbee

Batterie: CR2032

Betriebstemperatur: -10°C bis +50°C (14°F bis 122°F)

Betriebsfeuchtigkeit: 0 – 95% RH, keine Kondensation

Maximale Übertragungsleistung (Zigbee): 9,9dBm

Betriebsfrequenz: 2400MHz 2483,5MHz

Online-Kundendienst: www.aqara.com/support

E-Mail: support@aqara.com

Hersteller: Lumi United Technology Co., Ltd.

Adresse: 8th Floor, JinQi Wisdom Valley, No.1 Tangling Road,
Liuxian Ave, Taoyuan Residential District, Nanshan District,
Shenzhen, China.

Deutsch

